

- - - - - PROPOSED HYDRANT - THIS PROJECT
(SAPPHIRE PLACE DEVELOPMENT)
- - - - - PROPOSED HYDRANT - SEPARATE PROJECT
(WEST END HOMES DEVELOPMENT)
- - - - - PROPOSED HYDRANT - SEPARATE PROJECT
(ICON APARTMENT HOMES AT DOUGHERTY RANCH)
- - - - - EXISTING HYDRANT

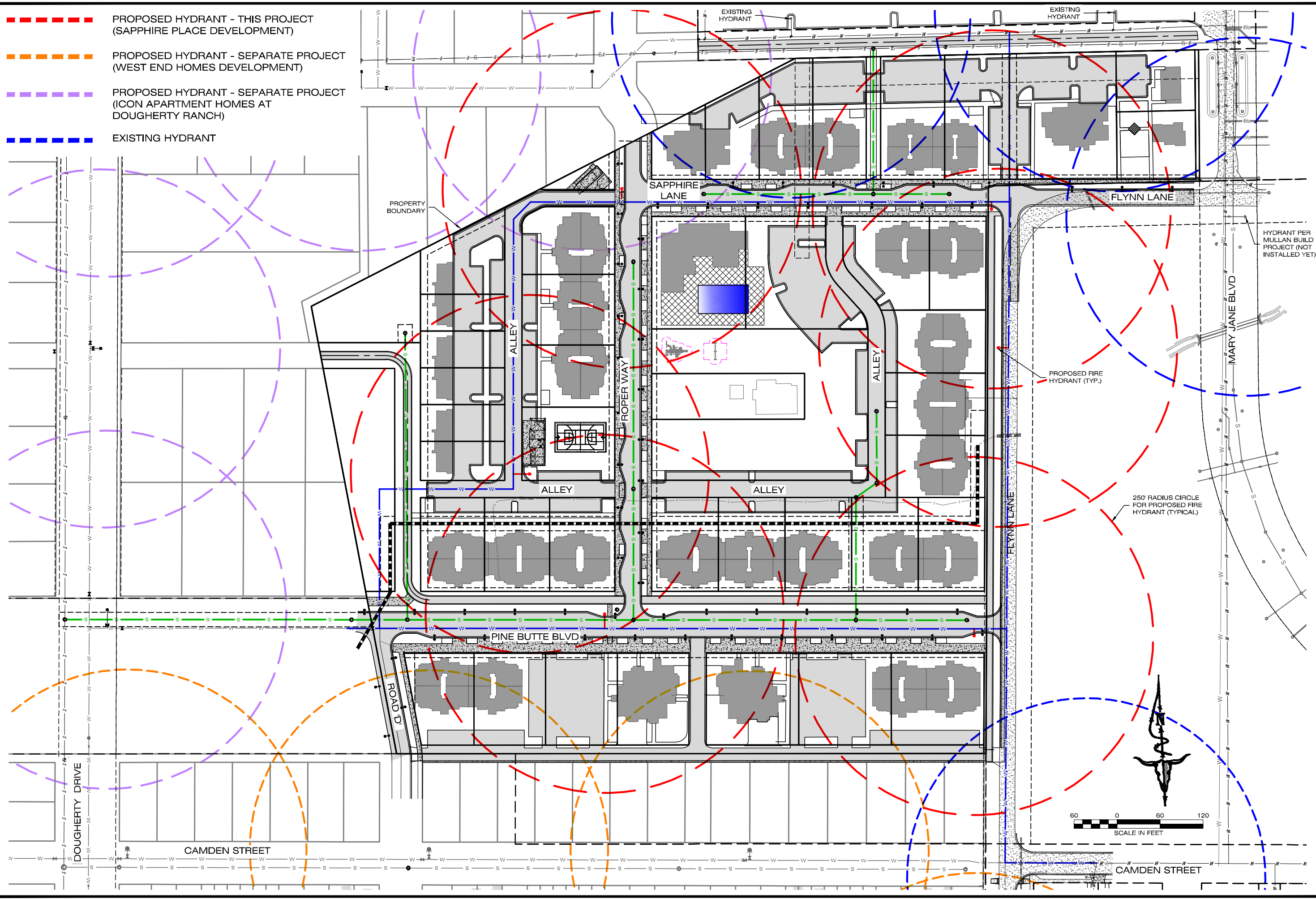

IMEG
 1817 SOUTH AVE. W. STE. A PH. 406.721.0142
 MISSOULA, MT FAX. 406.721.5224
 www.imegcorp.com 59801

DATE	
REVISIONS	

DESIGNED: _____
 DRAFTED: *AJM*
 CHECKED: _____
 DATE: 12/19/2022

LOCATION: 3285 FLYNN LANE
 PARCEL 2A OF C.O.S. 6689
 SECTION 7, T13N, R19W, P.M.M.
 MISSOULA, MISSOULA COUNTY, MT
 PREPARED FOR: CATHCART GROUP

PROJECT NAME: SAPPHIRE PLACE
 SHEET TITLE: HYDRANT LAYOUT

PROJECT NO. 21001343
 SHEET: 1 OF 1

PRELIMINARY

DRAWING LOCATION: \\P:\PROJECTS\2022\21001343\20220818\21001343-001\21001343-001\21001343-001.dwg DATE: 12/19/2022 8:15 AM